

## VL-Classic Pump

- Max. vacuum level : **-80 kPa** (-23.62 inHg)
- Max. flow rate : **2061 NI/min** (72.78 scfm)
- Supply air pressure : **4~6bar, max 7bar**  
(58~87 psi, max 101.5psi)
- Supply air type : Dry compressed air
- Working temperature : -20°C ~ 80°C
- Noise level : 50~65 dBA



### Main Advantages

VL-Classic pumps produces the high flow rate gradually while vacuum level is increasing so it is useful for leakage system. Vtec Air Saving kit is available in this pump in order to maximum reduce the energy usage. VITON® & EPDM seals can be also stipulated as option.

### Order No.

## VTL25 - 1434 A - AS - A3 R3 - CL SG2 N V



#### ① Model - Capacity equivalent to electricity motor pump size

- **VTL25** - 0.25KW
- VTL50 - 0.50KW
- VTL75 - 0.75KW
- VTL100 - 1.00KW
- VTL125 - 1.25KW
- VTL150 - 1.50KW
- VTL175 - 1.75KW
- VTL200 - 2.00KW

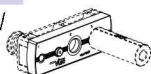

#### ② Connection plate

|                 | Air port | Vacuum port |          |
|-----------------|----------|-------------|----------|
| 1412 A          | G1/4"    | G1/2"       | Aluminum |
| • <b>1434 A</b> | G1/4"    | G3/4"       |          |
| 1401 A          | G1/4"    | G1"         |          |
| N1412 A         | NPT1/4"  | NPT1/2"     |          |
| N1434 A         | NPT1/4"  | NPT3/4"     |          |
| N1401 A         | NPT1/4"  | NPT 1"      | All PPS  |
| 1812 P          | G1/8"    | G1/2"       |          |
| 1834 P          | G1/8"    | G3/4"       |          |
| N1812 P         | NPT1/8"  | NPT1/2"     |          |
| N1834 P         | NPT1/8"  | NPT3/4"     |          |

#### ※ Remark :

- Air supply port with air control valve or AS-kit
- VTL25~VTL150 : G1/8"
- VTL175~VTL200 : G3/8"
- PPS Mat'l is available in VTL25L~ VTL125

#### ③ Air saving Kit

( 108 )

- No mark - Standard
- **AS** - Air saving kit attached

#### ④ Air supply control valve

- A1 - AC 110V
- A2 - AC 220V
- **A3** - DC 24V
- D1\* - AC 110V
- D2\* - AC 220V
- D3\* - DC 24V

D.\* : Double solenoid valve  
Double solenoid valve is available only with 'DN' or 'DL', section ⑥

#### ⑤ Vacuum release control valve

- R1 - AC110V
- R2 - AC220V
- **R3** - DC24V

#### ⑥ Solenoid Terminal

- DN - DIN type without lead wire
- DL - DIN type with lamp without lead wire
- **CL\*** - Connector type with lamp & 0.3m lead wire
- 2B\* - DIN type with '2 in 1' BUS cable  
(Air control v/v + Vacuum release v/v)
- 3B\* - DIN type with '3 in 1' BUS cable  
(Air control v/v + Vacuum release v/v + Digital switch)

\* Can not available with double solenoid valve

#### ※ Remark

- CL : Available only with DC24V  
Can not available with VTL175, VTL200
- 3B : Available only with DC24V  
Available only with 'S2' or 'S2P', section ⑦

☞ About 'BUS cable' ( 340, 341 )

#### ⑦ Vacuum switch

- S2(P) - Digital output 2points, No analog supply  
M8-4Pin male connector (0.3m lead wire)
- **SG2(P)** - Digital output 2points, No analog supply  
Grommet type 4-core 2m lead wire
- SG3(P) - Digital output 2points, Analog supply  
Grommet type 4-core 2m lead wire

※ Remark : ① S, (P)

↳ Output type : PNP open collector.

② VCM8 42 : M8-4Pin female connector, only for type S2(P)

#### ⑧ Non-return valve

- No mark - Standard
- **N** - Non-return valve

#### ⑨ Sealing

- No mark - Standard (NBR)
- **V** - Viton®
- E** - EPDM

## Characteristics

| Model  | max. vacuum<br>-kPa(-inHg) | Max.<br>vacuum<br>flow (NI/m) | air consumption<br>(NI/m) | noise level<br>(dBA) | weight<br>(g) | min hose inner Ø (within 2m) |        |         |
|--------|----------------------------|-------------------------------|---------------------------|----------------------|---------------|------------------------------|--------|---------|
|        |                            |                               |                           |                      |               | air supply                   | vacuum | exhaust |
| VTL25  | 80<br>(23,62)              | 379                           | 78-105                    | 50 - 65              | 643           | >4                           | >12    | >12     |
| VTL50  |                            | 650                           | 156-210                   | 50 - 65              | 644           | >6                           | >15    | >15     |
| VTL75  |                            | 820                           | 234-315                   | 50 - 65              | 760           | >8                           | >19    | >22     |
| VTL100 |                            | 990                           | 312-420                   | 50 - 65              | 761           | >8                           | >19    | >22     |
| VTL125 |                            | 1090                          | 390-525                   | 60 - 65              | 877           | >10                          | >25    | >32     |
| VTL150 |                            | 1303                          | 468-630                   | 60 - 65              | 878           | >10                          | >25    | >32     |
| VTL175 |                            | 1682                          | 546-735                   | 60 - 65              | 994           | >10                          | >32    | >40     |
| VTL200 |                            | 2061                          | 624-840                   | 60 - 65              | 995           | >10                          | >32    | >40     |

## Vacuum flow in (NI/m) at different Vacuum level (-kPa)

| Model  | -inHg<br>-kPa | 0    | 2.95 | 5.9 | 8.85 | 11.81 | 14.76 | 17.71 | 20.67 |
|--------|---------------|------|------|-----|------|-------|-------|-------|-------|
|        |               | 0    | 10   | 20  | 30   | 40    | 50    | 60    | 70    |
| VTL25  |               | 379  | 200  | 139 | 94   | 51    | 40    | 28    | 18    |
| VTL50  |               | 650  | 374  | 266 | 176  | 102   | 77    | 56    | 36    |
| VTL75  |               | 820  | 490  | 370 | 245  | 138   | 116   | 92    | 49    |
| VTL100 |               | 990  | 607  | 473 | 323  | 197   | 152   | 109   | 69    |
| VTL125 |               | 1090 | 750  | 547 | 390  | 241   | 192   | 138   | 87    |
| VTL150 |               | 1303 | 907  | 614 | 456  | 282   | 228   | 162   | 102   |
| VTL175 |               | 1682 | 1060 | 678 | 515  | 314   | 267   | 189   | 118   |
| VTL200 |               | 2061 | 1217 | 729 | 574  | 363   | 294   | 218   | 134   |

**VACUUM  
PUMPS**

## Time in seconds to evacuate to vacuum level (sec/l)

| Model  | -inHg<br>-kPa | 2.95   | 5.9   | 8.85  | 11.81 | 14.76 | 17.71 | 20.67 |
|--------|---------------|--------|-------|-------|-------|-------|-------|-------|
|        |               | 10     | 20    | 30    | 40    | 50    | 60    | 70    |
| VTL25  |               | 0,017  | 0,045 | 0,09  | 0,18  | 0,34  | 0,53  | 0,85  |
| VTL50  |               | 0,012  | 0,027 | 0,05  | 0,1   | 0,18  | 0,27  | 0,43  |
| VTL75  |               | 0,008  | 0,021 | 0,04  | 0,08  | 0,13  | 0,2   | 0,32  |
| VTL100 |               | 0,0069 | 0,015 | 0,03  | 0,05  | 0,09  | 0,14  | 0,22  |
| VTL125 |               | 0,0058 | 0,014 | 0,026 | 0,044 | 0,076 | 0,118 | 0,19  |
| VTL150 |               | 0,0049 | 0,013 | 0,022 | 0,037 | 0,062 | 0,095 | 0,15  |
| VTL175 |               | 0,0047 | 0,012 | 0,021 | 0,035 | 0,057 | 0,087 | 0,14  |
| VTL200 |               | 0,0043 | 0,011 | 0,019 | 0,033 | 0,051 | 0,078 | 0,12  |

## Dimensional Information

### Standard

### with AS - KIT

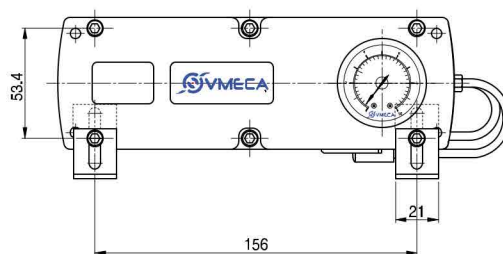
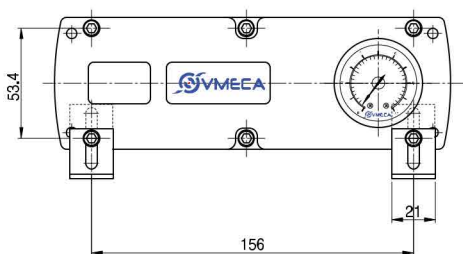
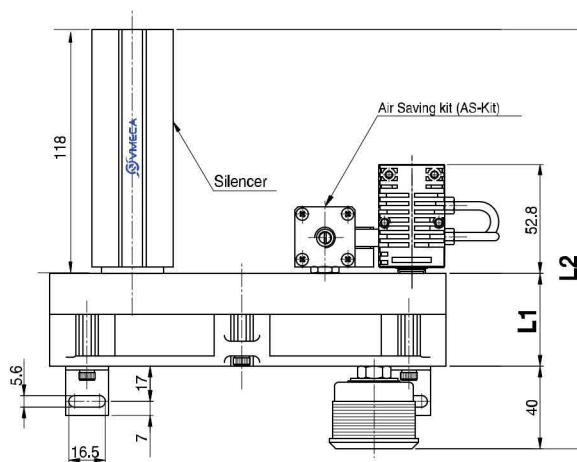
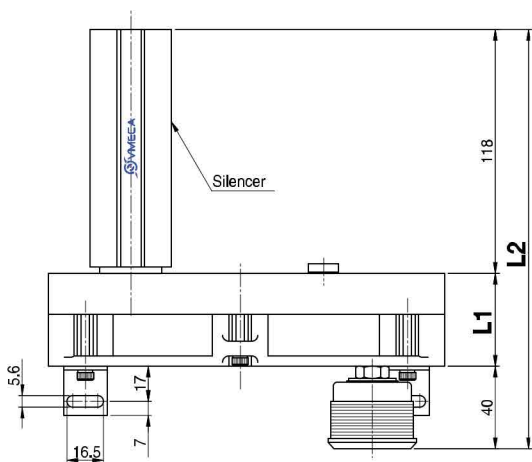
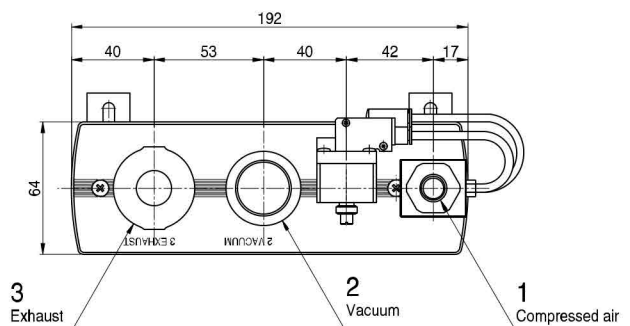
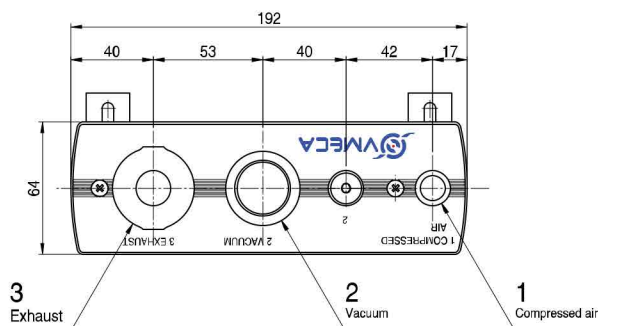

[ Measure unit : mm ]

(mm)

Port 1 : G1/4", NPT1/4"  
 Port 2 : G1/2", G3/4", G1"  
 NPT1/2", NPT3/4", NPT 1"  
 Port 3 : G3/4"

| Model  | L1   | L2    |
|--------|------|-------|
| VTL25  | 45.5 | 203.5 |
| VTL50  | 45.5 | 203.5 |
| VTL75  | 65   | 223   |
| VTL100 | 65   | 223   |
| VTL125 | 84.5 | 242.5 |
| VTL150 | 84.5 | 242.5 |
| VTL175 | 104  | 262   |
| VTL200 | 104  | 262   |

Port 1 : VTL25~VTL150 : G1/4", NPSF 1/4"  
 VTL175~VTL200 : G3/8", NPSF 3/8"  
 Port 2 : G1/2", G3/4", G 1"  
 NPT1/2", NPT3/4", NPT 1"  
 Port 3 : G3/4"

Dimensional Information

- Air supply control valve
- Vacuum release control valve
- Digital display vacuum switch

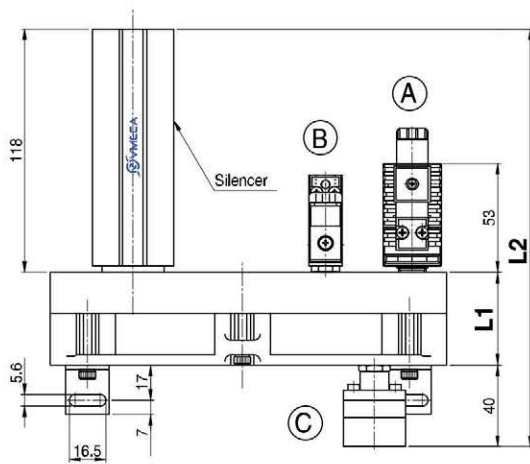
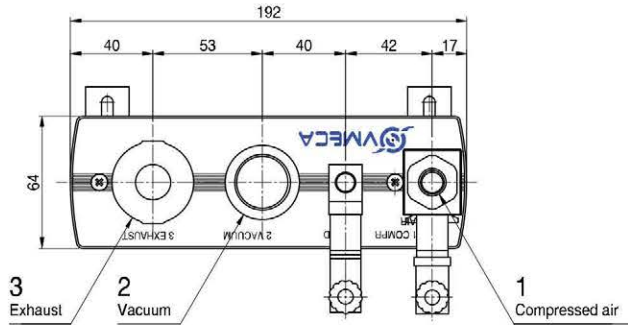

- (A) Air supply control valve
- (B) Vacuum release control valve
- (C) Digital display vacuum switch

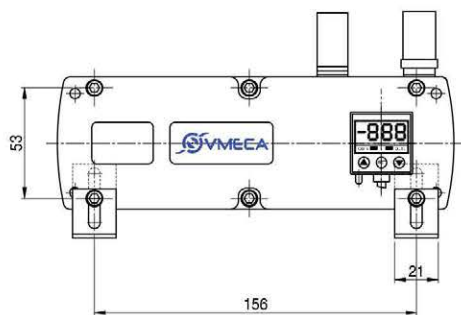

[ Measure unit : mm ]

(mm)

Port 1 : VTL25~VTL150 : G1/4", NPSF 1/4"  
 VTL175~VTL200 : G3/8", NPSF 3/8"  
 Port 2 : G1/2", G3/4", G 1"  
 NPT1/2", NPT3/4", NPT 1"  
 Port 3 : G3/4"

| Model  | L1   | L2    |
|--------|------|-------|
| VTL25  | 45.5 | 206.5 |
| VTL50  | 45.5 | 206.5 |
| VTL75  | 65   | 226   |
| VTL100 | 65   | 226   |
| VTL125 | 84.5 | 245.5 |
| VTL150 | 84.5 | 245.5 |
| VTL175 | 104  | 265   |
| VTL200 | 104  | 265   |

VACUUM PUMPS

